

# Disc valves RK, RKT and RKPK

TECHNICAL DATA

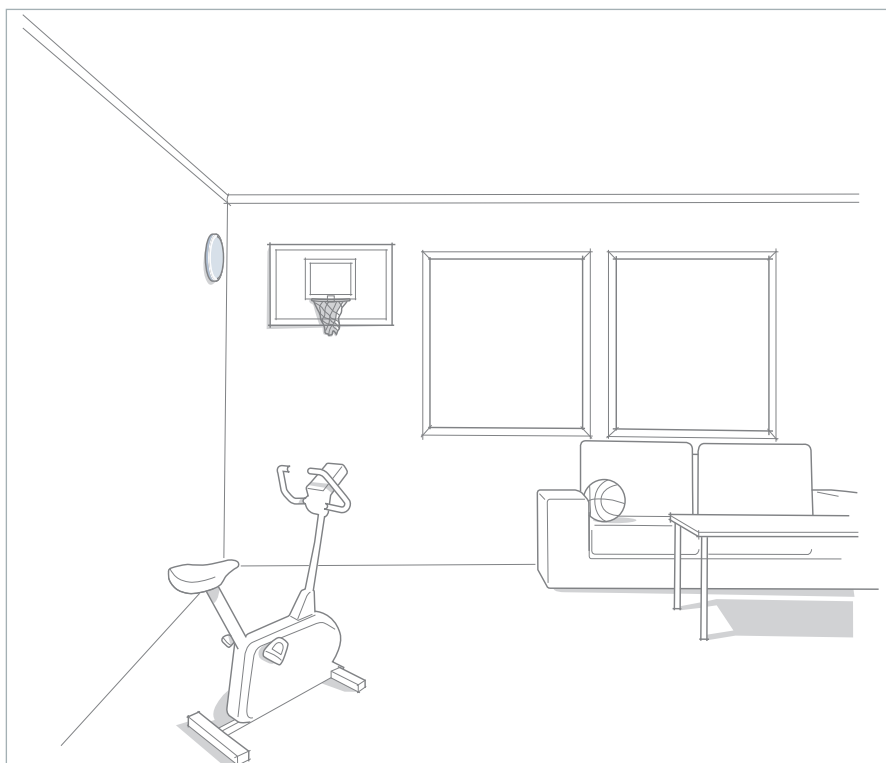



## RK, RKT AND RPKK DISC VALVES

RK, RKT and RPKK are designed for natural exhaust ventilation. They can also be used as supply and fresh air valves.

## QUICK SELECTION

Size	Connection mm	Air flow range (l/s) when slot 15 mm and pressure drop		
		50 Pa	100 Pa	150 Pa
63	63	12	17	22
80	80	24	33	41
100	100	23	32	35
125	125	32	43	54
160	160	45	62	80
200	200	60	85	100
250	250	60	90	110
315	315	90	130	160



## SPECIFICATIONS

- Easy to install
- Three disc material alternatives: plastic, stove enamelled steel and impregnated common alder

## PRODUCT CODE EXAMPLE

Disc valve RKT-200

## SELECTION DIAGRAMS

**Size 60**

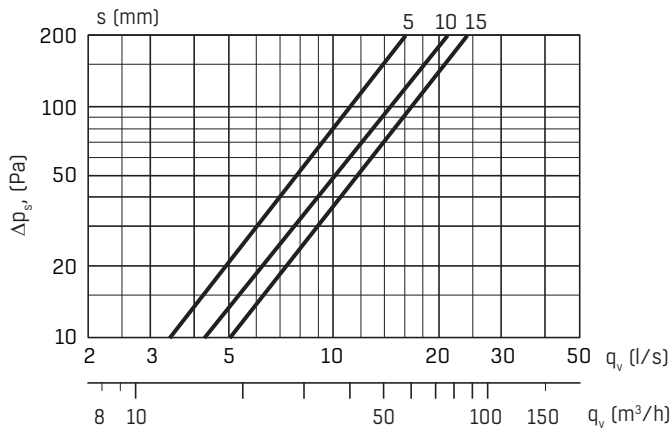

**Size 80**

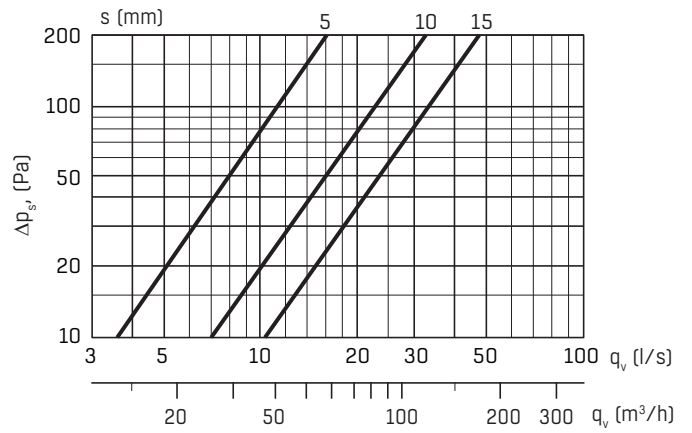

**Size 100**

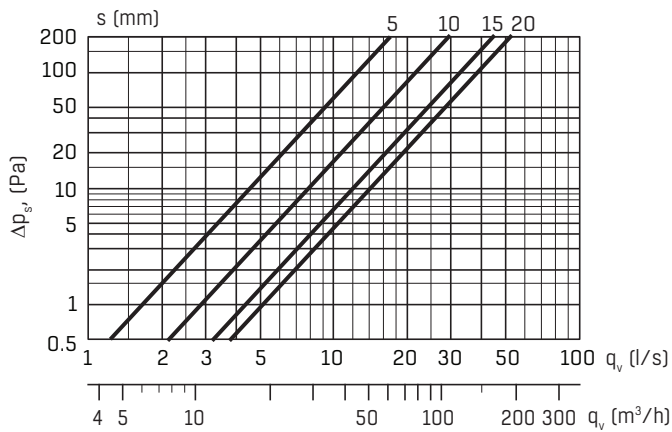

**Size 125**

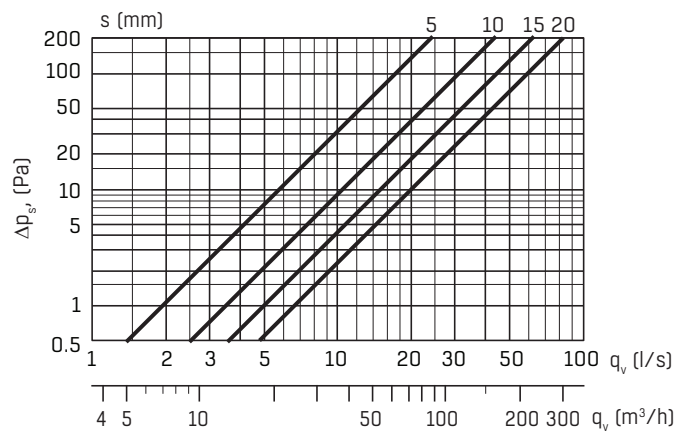

**Size 160**

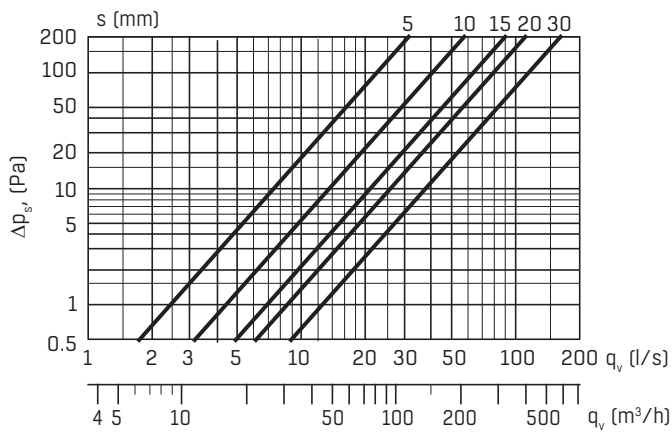

**Size 200**

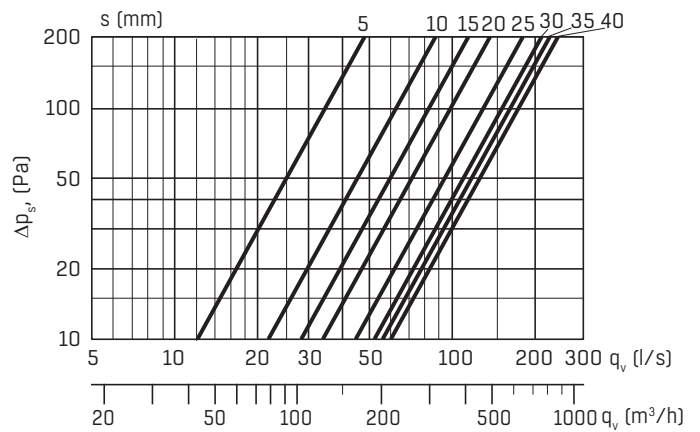

## SELECTION DIAGRAMS, DIMENSIONS AND WEIGHTS

## SELECTION DIAGRAMS

## Size 250

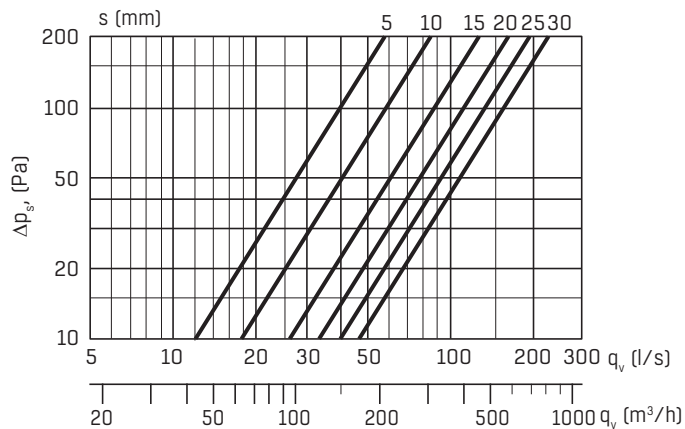

## Size 315

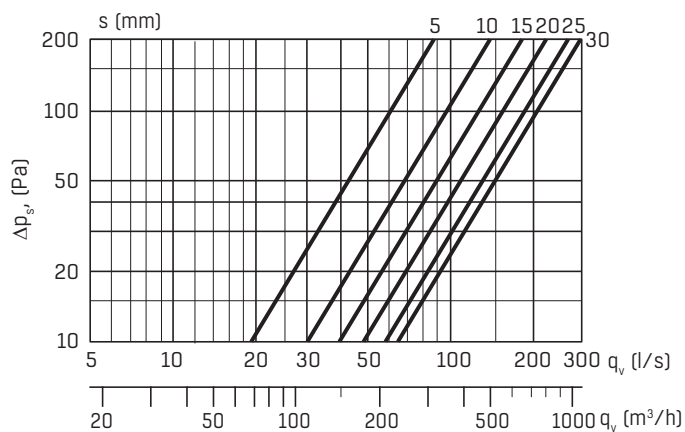

## DIMENSIONS AND WEIGHTS

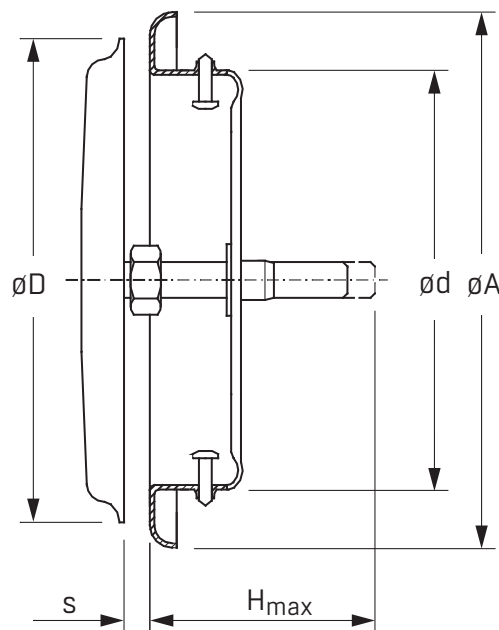

## RK

Nominal size	ØD (mm)	ØA (mm)	Ød (mm)	Hmax (mm)	Weight (g)
063	100	80	57	35	0,11
080	100	100	77	35	0,14
100	125	120	97	45	0,17
125	150	150	122	45	0,24
160	190	190	157	55	0,35
200	230	230	197	55	0,45

## RK-PK

Nominal size	ØD (mm)	ØA (mm)	Ød (mm)	Hmax (mm)	Weight (g)
100	125	120	97	45	0,19
125	150	150	122	45	0,26
160	190	190	157	55	0,37

## RKT

Nominal size	ØD (mm)	ØA (mm)	Ød (mm)	Hmax (mm)	Weight (g)
063	90	80	57	35	0,12
080	90	100	77	35	0,16
100	110	120	97	45	0,19
125	140	150	122	45	0,26
160	180	190	157	55	0,37
200	220	230	197	55	0,50
250	275	270	240	65	1,05
315	340	330	301	60	1,53

## GENERAL AND PRODUCT CODE

### APPLICATION

RK is designed for natural exhaust ventilation. It can also be used as a supply and fresh air valve. RK is easy to install and available in three alternative disc materials.

### INSTALLATION

The valve is fixed to a duct by means of two screws (included), turning the screws from the inside of the valve body. Valves of sizes 100 - 200 can be mounted without screws to a covering plate MPL.

### MATERIAL

Product	Material		
	Disc	Body	Screw
RK	Plastic	Stove enamelled steel	Zinccoated steel
RKT	Stove enamelled steel	Stove enamelled steel <sup>1)</sup>	Zinccoated steel
RPKK	Impregnated common alder	Stove enamelled steel	Zinccoated steel

<sup>1)</sup> sizes 250 and 315 aluminium

### DESCRIPTIVE TEXT

Disc valve RK, e.g RKT-315 manufactured by FläktGroup.

### PRODUCT CODE

**Disc valve, plastic** **RK-aaa**

**Size (aaa)**  
63, 80, 100, 125, 160, 200

**Disc valve, stove enamelled steel** **RKT-aaa**

**Size (aaa)**  
63, 80, 100, 125, 160, 200, 250, 315

**Disc valve, impregnated common** **RKPK-aaa**

**Size (aaa)**  
100, 125, 160

### ACCESSORIES

**Covering plate** **MPL-aaa**

**Size (aaa)**  
100, 125, 160, 200

## **EXCELLENCE IN SOLUTIONS**

FläktGroup is the European market leader for smart and energy efficient Indoor Air and Critical Air solutions to support every application area. We offer our customers innovative technologies, high quality and outstanding performance supported by more than a century of accumulated industry experience. The widest product range in the market, and strong market presence in 65 countries worldwide, guarantee that we are always by your side, ready to deliver Excellence in Solutions.

### **PRODUCT FUNCTIONS BY FLÄKTGROUP**

Air Treatment | Air Movement | Air Diffusion | Air Distribution | Air Filtration  
Air Management & ATD's | Air Conditioning & Heating | Controls | Service

» Learn more on [www.flaktgroup.com](http://www.flaktgroup.com)  
or contact one of our offices