

Take-off

ILU

- 1
- 2
- 3
- 4
- 5
- 6
- 7
- 8
- 9
- 10
- 11
- 12
- 13
- 14
- 15
- 16
- 17
- 18



Dimensions

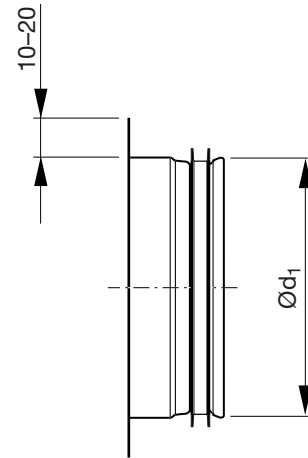

Description

Take-off without radius.

| Ød ₁ nom | m kg |
|------------------------|---------|
| 63 | 0,07 |
| 80 | 0,07 |
| 100 | 0,08 |
| 112 | 0,09 |
| 125 | 0,11 |
| 140 | 0,12 |
| 150 | 0,12 |
| 160 | 0,16 |
| 180 | 0,15 |
| 200 | 0,17 |
| 224 | 0,23 |
| 250 | 0,33 |
| 280 | 0,37 |
| 300 | 0,40 |
| 315 | 0,42 |
| 355 | 0,48 |
| 400 | 0,65 |
| 450 | 0,74 |
| 500 | 0,82 |
| 560 | 1,13 |
| 600 | 1,21 |
| 630 | 1,27 |
| 710 | 2,12 |
| 800 | 2,39 |
| 900 | 2,69 |
| 1000 | 3,57 |
| 1120 | 3,99 |
| 1250 | 4,46 |

Ordering example

